

REAR WHEEL REPLACEMENT INSTRUCTIONS

SII057 6/13

⚠️ WARNING: Keep wheels at the recommended tire pressure as specified on the tire wall. Inflate tires using only a manual bike pump with a tire gauge. Do not use gas station air pumps as they can cause the inner-tube to burst creating a Projectile Hazard and serious risk of injury.

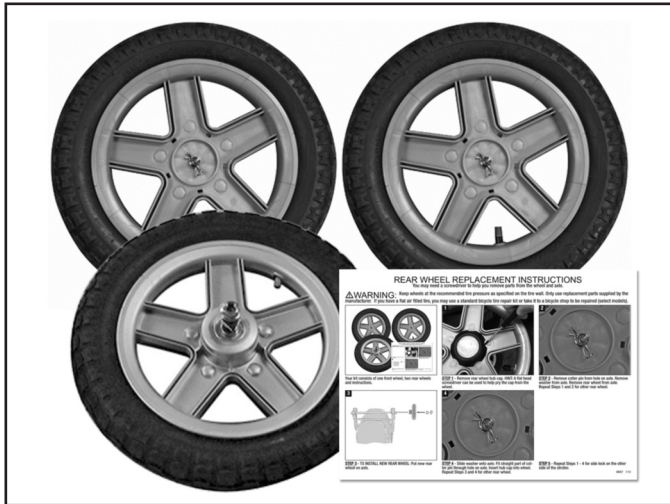

Your kit consists of one front wheel, two rear wheels and instructions. If you have questions, please call Kolcraft's consumer service at (800) 453-7673.



TOOLS NEEDED:

For Rear Wheel replacement, a flat-tip screwdriver.

For Front Wheel replacement, two (2) adjustable wrenches.



STEP 1 - Unfold the stroller and position it with the rear wheels upward as shown.



STEP 2 - Remove rear wheel hub cap, using a flat-tip screwdriver. Pry the cap from the wheel.



STEP 3 - Remove cotter pin from hole on axle. Remove washer from axle. Remove rear wheel from axle. NOTE: Keep cotter pins and washers to install new wheels.

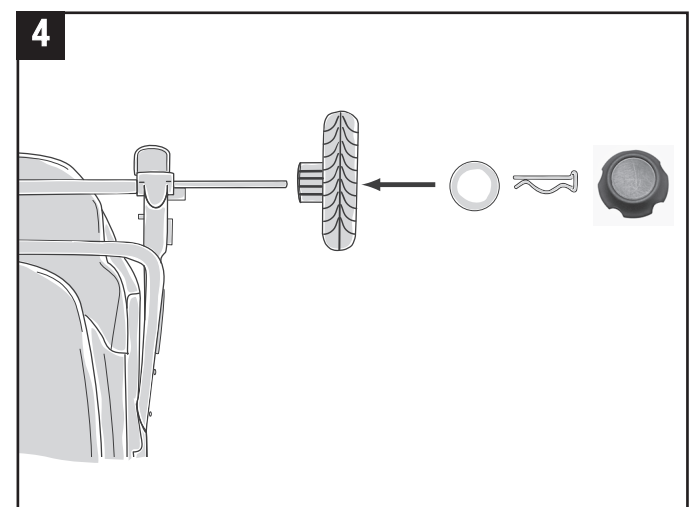

STEP 4 - TO INSTALL NEW REAR WHEEL: Put new rear wheel on axle. Slide washer onto axle. Fit straight part of cotter pin through hole on axle. Insert hub cap into wheel. Repeat Steps 2 through 4 for other rear wheel.

FRONT WHEEL REPLACEMENT INSTRUCTIONS

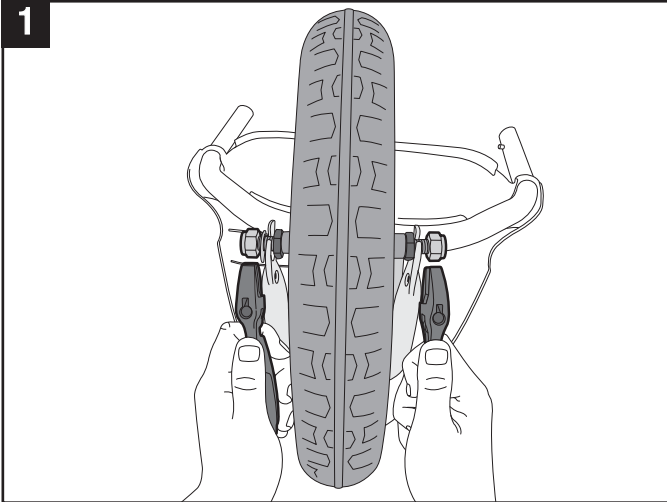

STEP 1 - Position stroller, so that the handle and rear wheels are resting flat on the floor. While holding one outer nut in place with your first wrench, use the other wrench to loosen the outer nut on the opposite side. Repeat for other side.

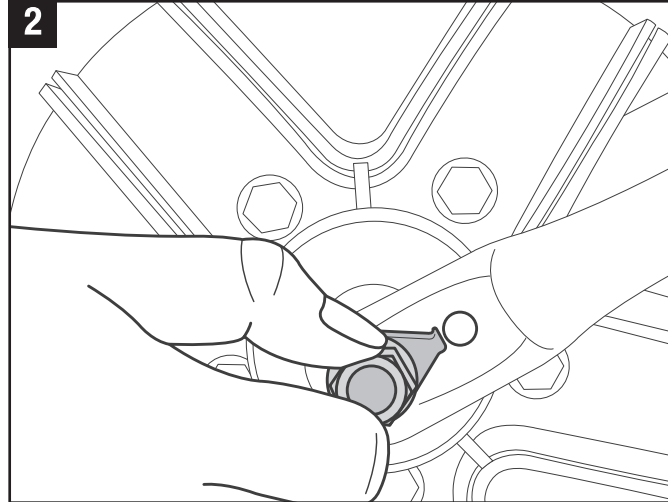

STEP 2 - Remove the tab on the tear drop shaped washer from the hole on the front fork. Repeat for other side. Remove wheel from front fork.

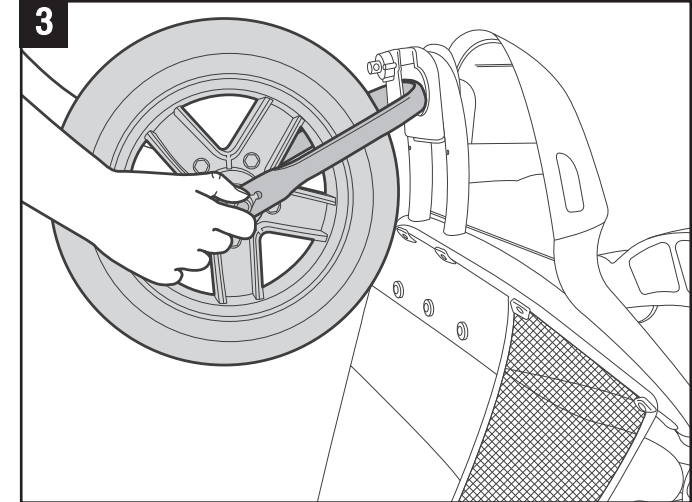

STEP 3 - TO INSTALL NEW FRONT WHEEL: You may need to loosen the nuts on both ends of the axle in order to make room for the front wheel fork.

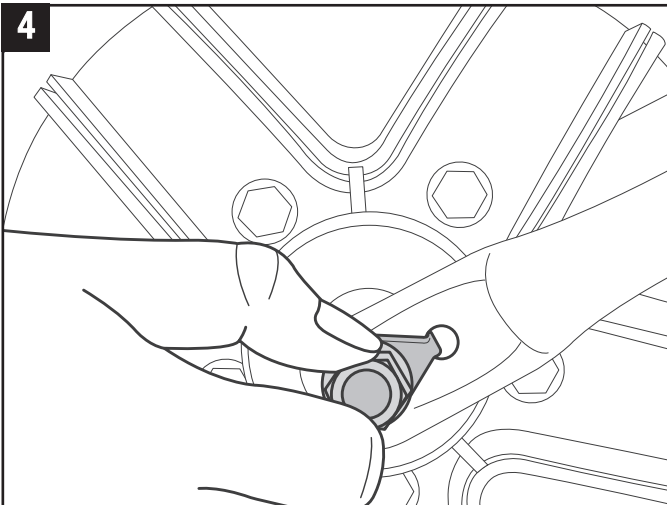

STEP 4 - Ensure that the tab on the tear drop shaped washer is aligned with the hole on the front fork as shown. Repeat for other side.

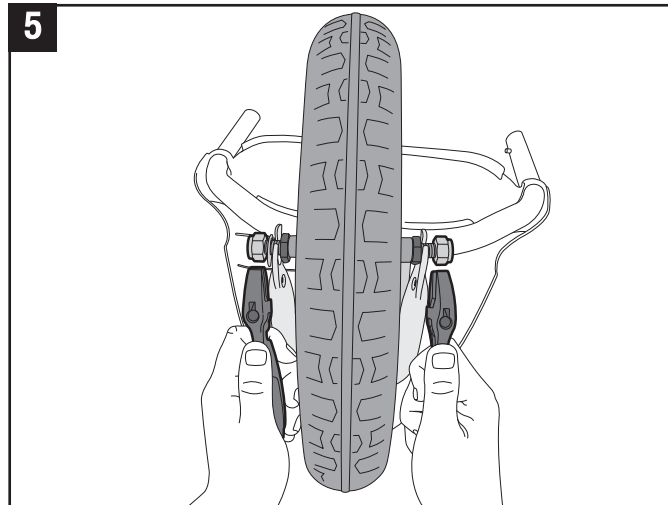

STEP 5 - While holding one outer nut in place with your first wrench, use the other wrench to tighten the outer nut on the opposite side.

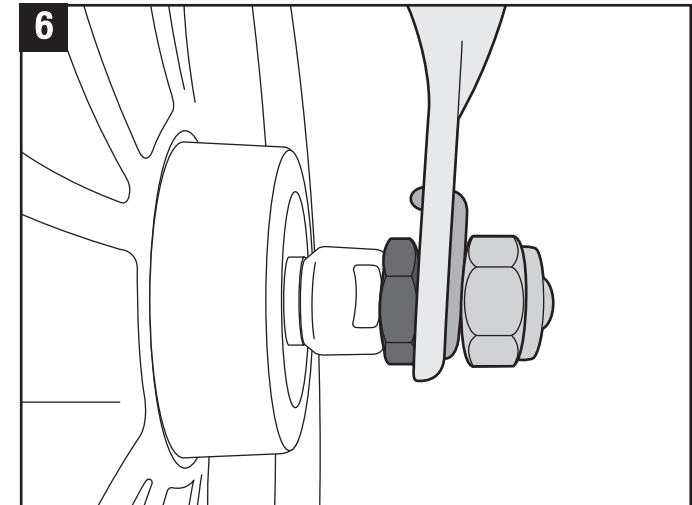

STEP 6 - Tighten until the front wheel fork is touching the inner black nut and the tear drop shaped washer. Repeat for other side.

TO PROPERLY DISPOSE OF OLD WHEELS, WRITE "RECALLED" ON EACH WHEEL USING PERMANENT MARKER BEFORE PLACING IN YOUR GARBAGE. IT IS ILLEGAL TO SELL RECALLED WHEELS.