

# TINY STEPS™

2-in-1 Activity Walker



**2 MODES**  
grow with your child

5

5 fun activities



Height-adjustable seat



Child tray with built-in  
cupholder is easy to clean

# Kolcraft®



Scan for instructional video



Escanee para obtener  
instrucciones en español

Model #: KW029  
W031-R3 06/2022

# WARNING

Read all instructions BEFORE assembly and USE of the walker. Failure to follow these warnings and instructions could result in serious injury or death. For your child's safety, read the labels and the instructions before using product. Keep instructions for future use.

## **IMPORTANT SAFETY INFORMATION:**

### **How to Keep Your Child Safe While Using this Product**

- **NEVER** leave child unattended. Always keep child in view while **IN WALKER**.
- **CAUTION: Toys intended to be assembled by adult! Toys are intended to be played with while attached to the walker and are not intended to be played with when not attached to the walker.**

- **CHOKING HAZARD-Small parts. ADULT ASSEMBLY REQUIRED.**

This package contains small parts which, before assembly, present a choking hazard to children under the age of three. Care should be taken during unpacking and assembly to ensure that all small parts and plastic bags are accounted for and kept out of the reach of children. All fasteners should be fully tightened.

### **STAIR HAZARD**

- Avoid serious injury or death. Block stairs / steps securely before using this walker.
- Use only on flat surfaces free of objects that could cause this walker to tip over. Never use near stairs, steps, thresholds, hills, roadways, or pools.
- To avoid burns, keep child away from hot liquids, stoves, radiators, space heaters, fireplaces, etc.
- Discontinue using this walker should it become damaged or broken.
- Never carry this walker with child in it. Never adjust seat while child is in product.
- **DO NOT** lift or carry by tray or toys.
- **DO NOT** use this walker until baby can sit up unassisted.
- To reduce the chance of child slipping out of seat, check that both feet of child touch the floor.
- Discontinue use of activity walker (seated stage) when your child can stand unaided, walk unassisted or lift the walker off of the floor.
- To maintain stopping performance, clean friction strips regularly with damp cloth.

### **Only use this activity walker (seated stage) if your child MEETS ALL of the requirements below:**

1. Can support body weight with legs
2. Weight is between 15 and 26 pounds.
3. Height is less than 32 inches and child is not able to stand flat footed while in the walker.

### **CARE & MAINTENANCE**

1. Plastic Parts: Wipe clean with mild soap and a damp cloth. Air dry.
2. Seat Pad: Machine wash in cold water in gentle cycle.  
Air or hang dry. **DO NOT** use harsh detergents or bleach.  
**DO NOT** dry clean.

**NOTE:** To maintain stopping performance, clean friction strips regularly with damp cloth.

## PARTS LIST

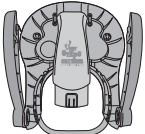

Tray & Legs

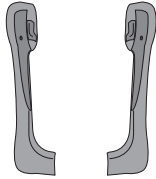

Side Base Legs (2)



Front Mount

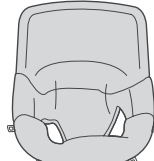

Seat Pad

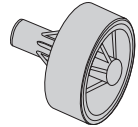

Rear Wheels (2)



Screws (8)



Axes (2)

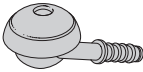

Front Casters (2)

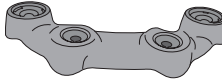

Toy Play Tray

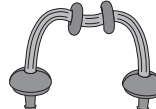

Bead Bar

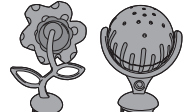

Upright Toys (2)

## HOW TO ASSEMBLE YOUR WALKER

### To Assemble Walker Frame

1

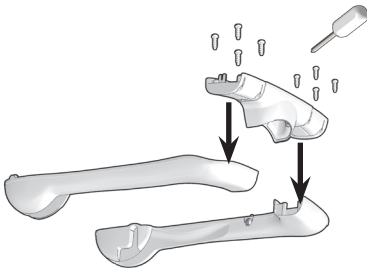

- 1 Flip over both side bases and front mount. Align as shown and push down. Attach the front mount to the side base legs using a Phillips screwdriver and the 8 screws provided (one-time assembly).

2

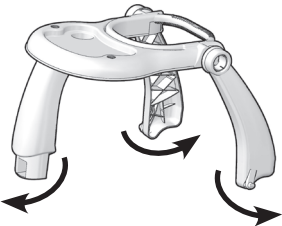

- 2 Locate the tray & legs, and unfold the legs outward as shown.

3

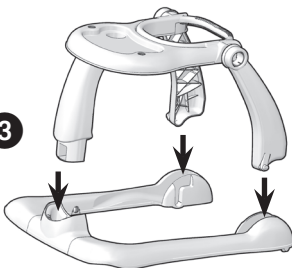

- 3 Flip the base. Align the rear legs and push down (one at a time) until each leg locks in place.

Align the front leg and press down on the top tray until the leg locks in place. Front leg button should be visible.

3

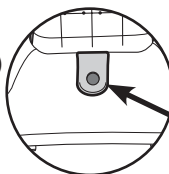

Front Leg Button

## Attach Seat Pad

High Back Support

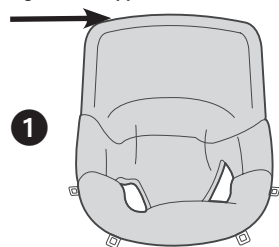

- 1 Place seat pad into seat ring located on tray. Align it so that high back support aligns with back of walker ring.

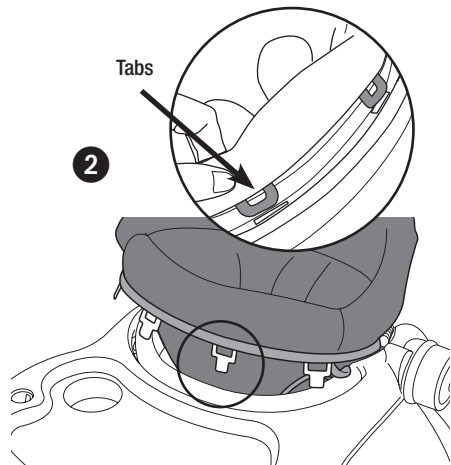

- 2 Insert the 4 tabs on the seat pad into slots located around the front of the seat ring. Slide tabs through holes.

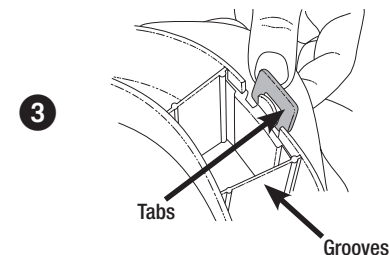

- 3 Underneath the tray, pull tabs and align into grooves.

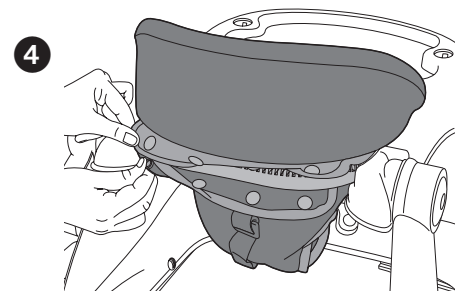

- 4 Snap the back of the seat pad around the rear of the seat ring.

**Test:** Push down hard on seating area of seat pad to make sure seat is securely in place.

**CAUTION:** Do not use walker if all tabs are not secured properly, otherwise child may fall through walker.

## Attach Rear Wheels

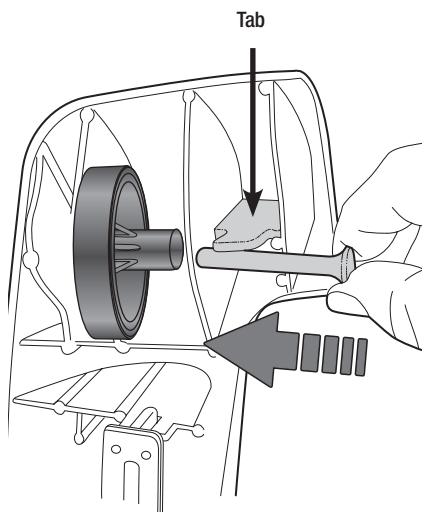

- 1 Flip base over to expose underside. Locate rear wheel opening in base of the walker.
- 2 Align holes of wheel with corresponding axle holes on the base of the walker. Plastic tab may need to be pushed to the side to expose the axle hole. The stem of the wheel should be facing the inside of the base.
- 3 Slide metal axle into holes from the inside towards the outside of the base until the head of the axle passes the plastic tab and the tab is able to hold the axle in place.
- 4 Repeat for other wheel.

## Attach Front Casters

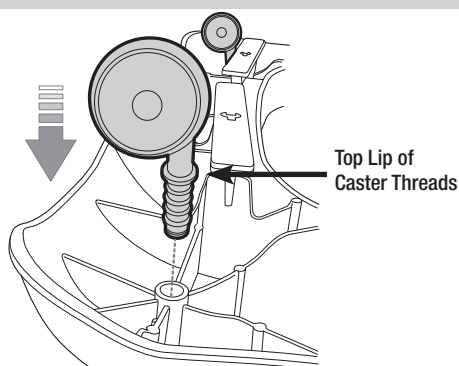

- 1 Insert the stem of one of the front casters into the hole in one of the front corners. Push firmly until the caster snaps (locks) into place. Pull up on caster to make sure it is locked in place. Flip base right side up.

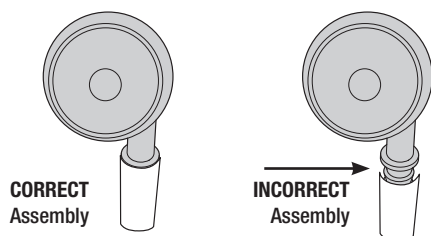

**CAUTION:** Be sure the caster is inserted fully into the base. The top lip of the caster threads should be flush with the base hole. Nothing below this lip should be visible.

## To Attach Toys

**⚠ WARNING**  
Do Not lift walker by toys or tray.

**CAUTION:** Toys intended to be assembled by adult!

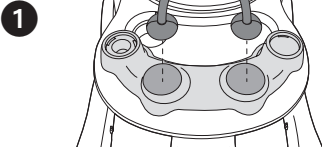

- 1** Insert bead bar into the two center slots of the play tray. Be sure bead bar is pointed towards seating area as shown in image.

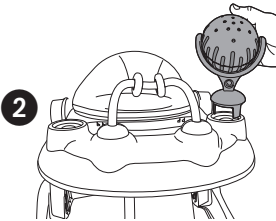

- 2** Insert tabs of ball toy into toy play tray until it snaps into place.

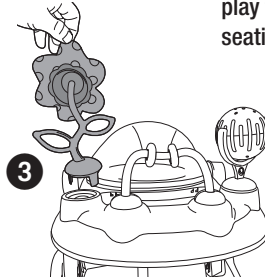

- 3** Insert tabs of flower toy into toy play tray until it snaps into place.

## To Remove Play Tray

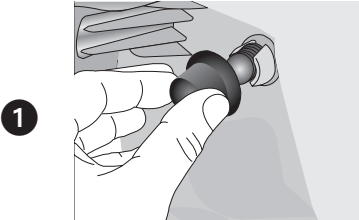

- 1** Unscrew nuts from underneath toy play tray.

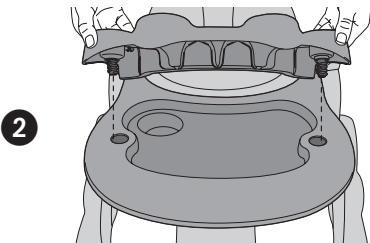

- 2** Lift up tray to remove.

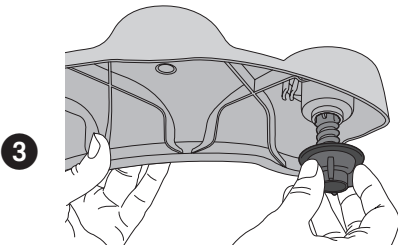

- 3** Re-screw nuts onto bolts for safe keeping.

### TO REATTACH PLAY TRAY:

Reverse steps above, making sure to screw nuts onto bolts until nuts are firmly attached to the bolt. The toy play tray should not move.

## To Convert to Walk-Behind Walker

As your child grows, your Tiny Steps® Walker can be converted to a Walk-Behind Walker.

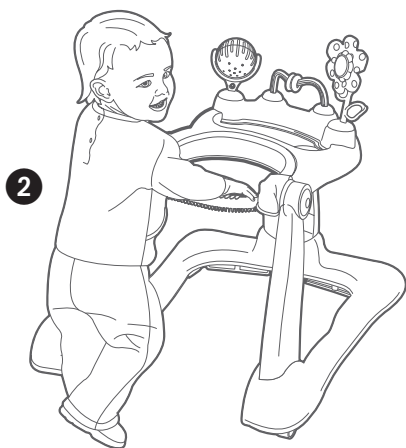

- 1 Remove the seat pad by unfastening the 4 seat tabs from the tray and unsnapping the rear of the seat pad.
- 2 Your child can now stand behind the walker, using the texturized handle grip for support as they learn how to walk in the walk-behind mode.

## To Adjust Seat Pad Height

### **WARNING**

**DO NOT** disassemble or adjust height while baby is sitting in or near product. Always make sure seat pad is adjusted to the correct height position before placing child in product.

**NOTE:** As your child begins to grow, adjust height of walker via the seat pad so that their feet touch the ground when seated. To determine correct height after assembly, place child in walker and make sure both feet touch the ground.

**CAUTION:** Child should not be in the walker during adjustment.

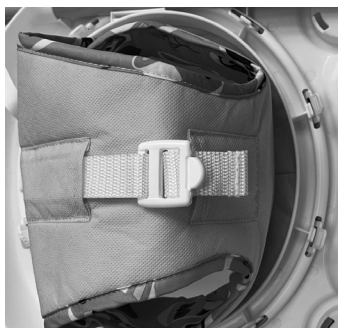

- 1 After seat pad is attached to tray, flip unit upside down to access the restraint strap on underside of seat pad.
- 2 Please note, to ensure proper operation, you will need to periodically adjust the seat restraint to accommodate your child's increased height. For **smaller babies**, seat pad should be extended to its lowest position. To adjust seat height, push button in on restraint strap to release restraint.
- 3 As baby grows, raise seat by tightening belt. This helps to prevent the child from placing their feet flat on ground and prevents your child from climbing out.



## To Fold Walker

The walker folds easily for travel & storage.  
For a smaller fold, remove the toy play tray.

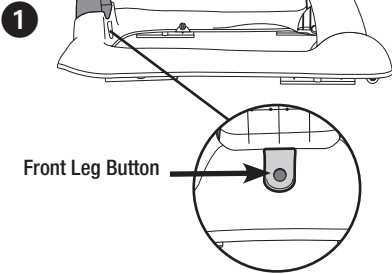

- 1 Release the front leg from the base by pressing the leg release button and pulling up firmly on the front leg.

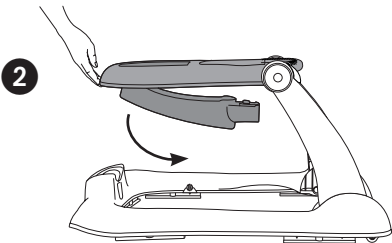

- 2 Fold the front leg under the tray until it locks onto the tray itself.

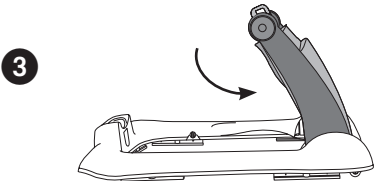

- 3 Rotate the tray down and to the rear of the walker.

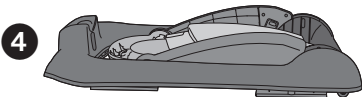

- 4 Fold legs forward.

Please direct any comments, questions or replacement part requests to:  
Kolcraft® Consumer Service Department  
1100 W Monroe St. Chicago, IL 60607  
1-800-453-7673 in U.S., 1-312-361-6315 outside U.S.  
8 am-5 pm (CT) Monday - Thursday, 8 am - 3 pm Friday (CT)  
e-mail: [customerservice@kolcraft.com](mailto:customerservice@kolcraft.com)