

Kolcraft®

Cloud™ 360°

Stroller Wagon



Escanee para obtener
instrucciones en español

Model #: KT012
S160 02/2025

Kolcraft.com

WARNING

IMPORTANT SAFETY INFORMATION. DO NOT USE PRODUCT UNTIL YOU READ AND UNDERSTAND THESE INSTRUCTIONS.

KEEP INSTRUCTIONS FOR FUTURE USE. Failure to follow these warnings and the assembly instructions could result in serious injury or death.

Avoid serious injury from falling or sliding out. Always use restraint system.

How to Keep Your Child Safe While Using this Product

- **Adult assembly required.**
- **Never leave your child unattended while in the product.** Your child may become tangled in straps or pads and suffocate.
- **Always lock the product open before allowing your child in or near the product to prevent injuries caused by moving parts.**
- **Take care when folding and unfolding and keep children clear to prevent finger pinching.**
- **Always engage wheel brakes when product is not moving, especially on an incline, to prevent the product from rolling away.**
- Only use this product with two children who weigh no more than 55 lb (25 kg) each. Use by more or larger children may damage the product or cause a hazardous, unstable condition to exist.
- Do not exceed 110 lb (50 kg) total weight in the product.
- Do not exceed 0.5 lb (0.2 kg) in the interior storage pockets.
- Do not exceed 20 lb (9 kg) in the footwell compartment when used for storage.
- Do not exceed 3 lb (1.3 kg) in Front Storage Pockets.
- Do not exceed 2 lb (0.9 kg) in Canopy Storage.
- Do not exceed 3 lb (1.3 kg) in Parent Storage Pockets.
- Do not exceed 2 lb (0.9 kg) in Parent Organizer.
- Do not carry heavy loads while children are in the seating area.
- **Always distribute weight inside the product evenly for optimal handling.** To prevent tipover, do not place accessories other than those approved by Contours on the canopy or over the handle and follow all maximum weight limits or else the product may become unstable.
- **Never use the product on stairways or escalators.**
- **DO NOT** allow children to climb into product unassisted. Product may tip over and injure child.
- Do not allow children to stand or sit on the side rails of the wagon when getting in or out of the wagon.
- Always engage the product's brakes prior to placing children in or out of the product.
- Do not push down on height-adjustable handle to lift front wheels; doing so may cause the product to move unexpectedly or damage the product. Always ascend curbs by using the handles to lift product up.
- Always fully insert all four canopy tubes when using canopy.
- To prevent damage to the canopy, remove the canopy and canopy tubes from the product when storing.
- When product is folded, do not lift the product from the folded handle or canopy tubes.
- Only use replacement parts and accessories supplied by the manufacturer.

PARTS LIST

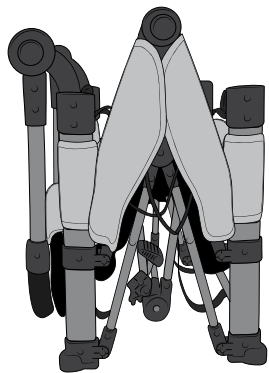

STROLLER WAGON FRAME

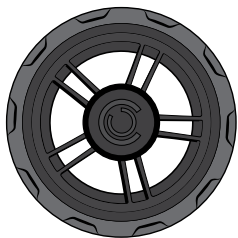

MIDDLE WHEEL (2)

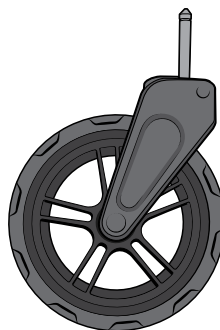

CORNER WHEEL (4)

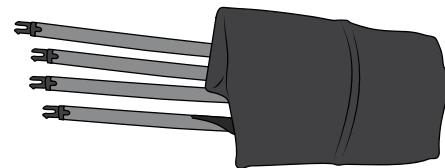

CANOPY

FEATURES LIST

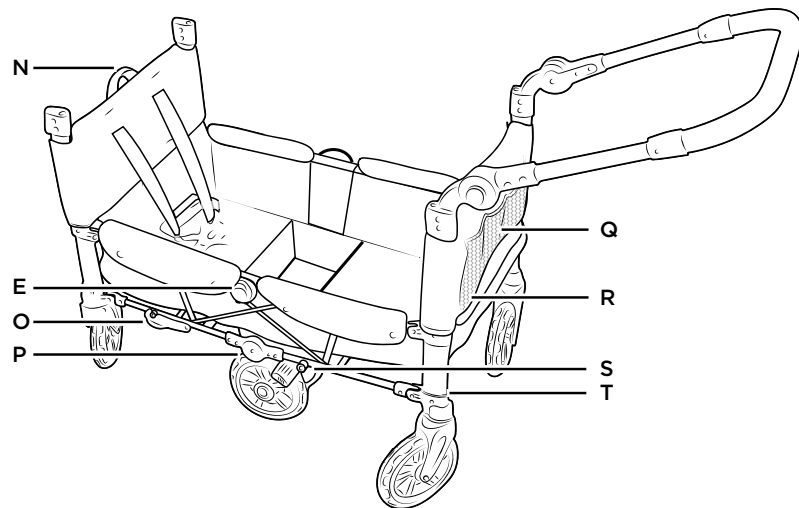
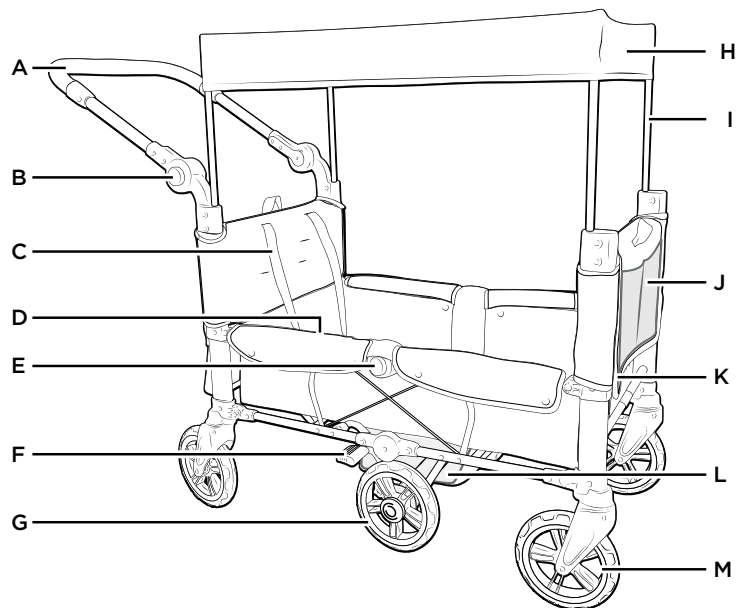

A Handlebar
B Height Adjustment Buttons
C Harness
D Interior Storage Pockets
E Fold Buttons
F Brake
G Middle Wheel

H Canopy
I Canopy Tubes
J Front Storage Pockets
K Canopy Storage
L Footwell
M Corner Wheels
N End Lift Handles

O Stroller Lock Latch
P Middle Wheel Release
Q Parent Storage Pockets
R Parent Organizer
S Stroller Lock Button
T Corner Wheel Release

ATTACH CORNER WHEELS

1-1 x4

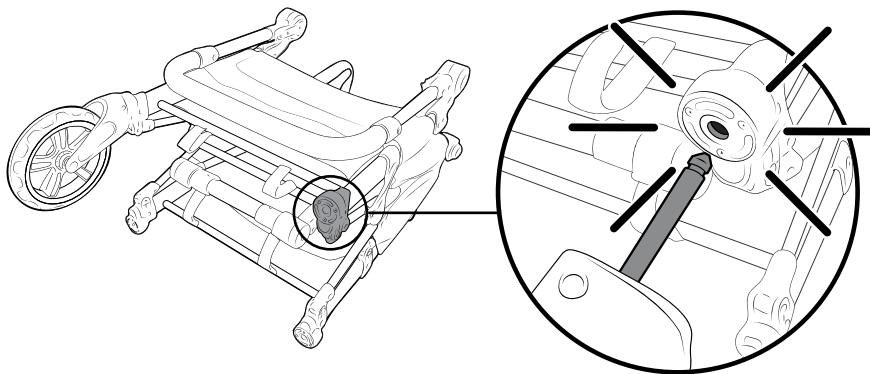

TO REMOVE

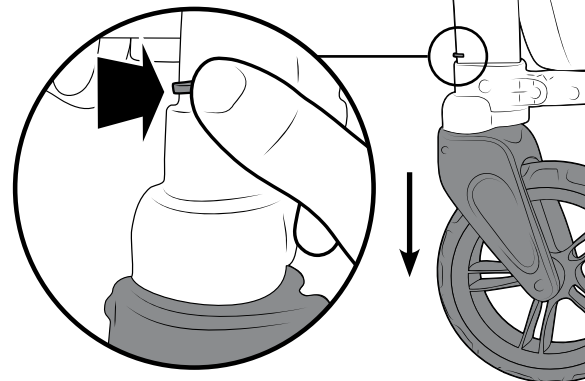

OPEN FRAME

2-1

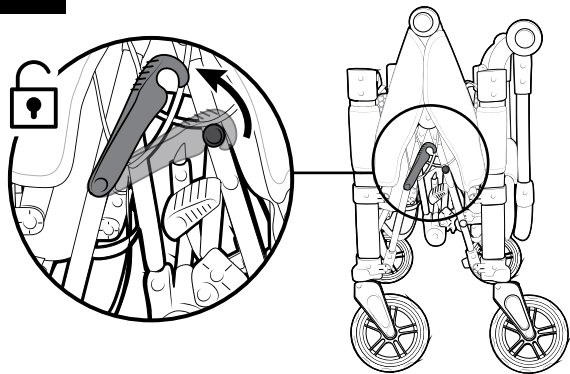

2-2

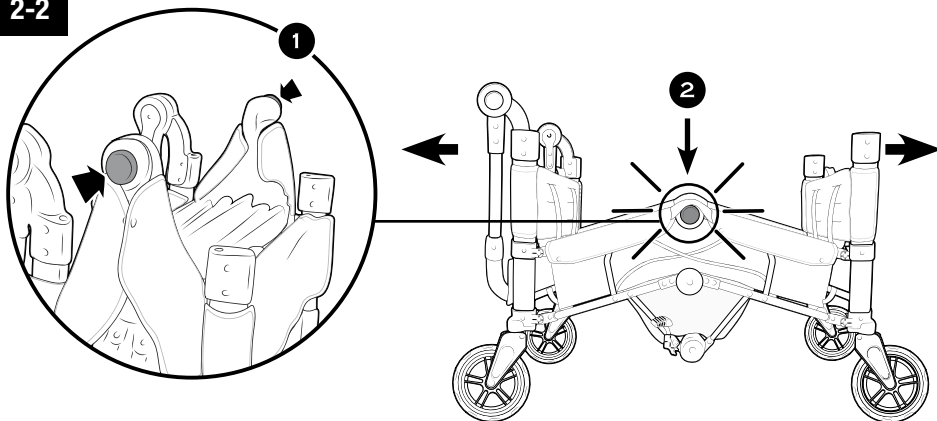

ATTACH MIDDLE WHEELS

3-1 x2

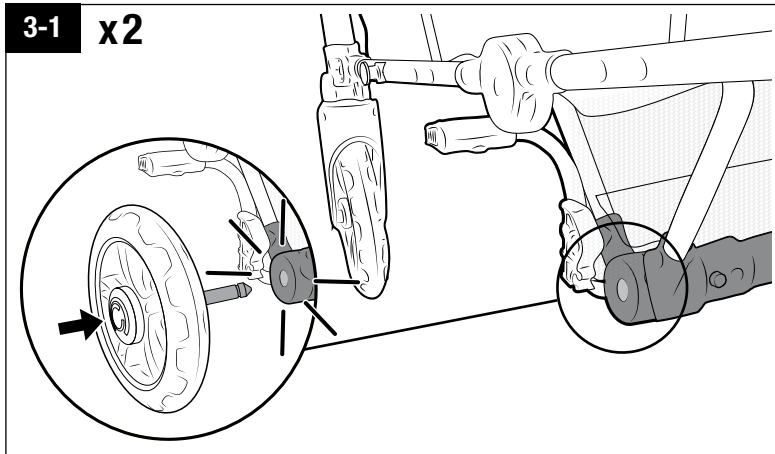

TO REMOVE

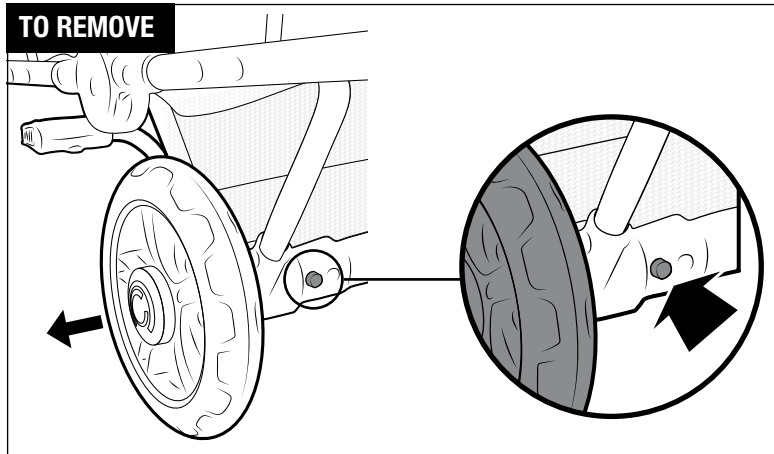

OPERATE BRAKES

4-1

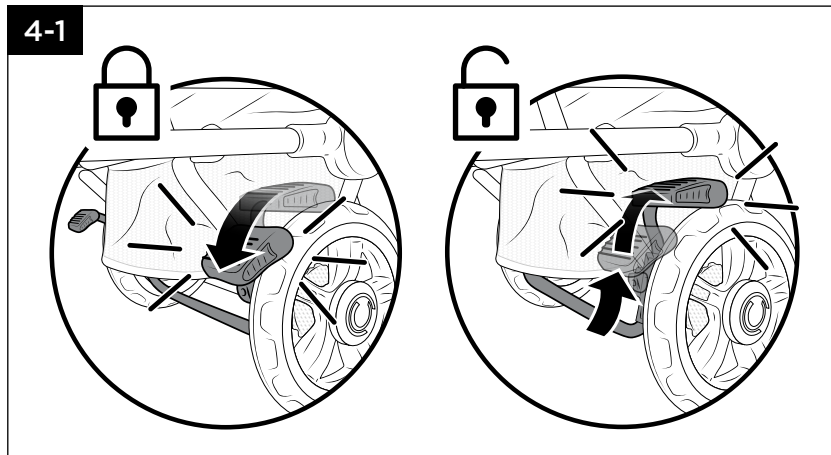

ATTACH CANOPY

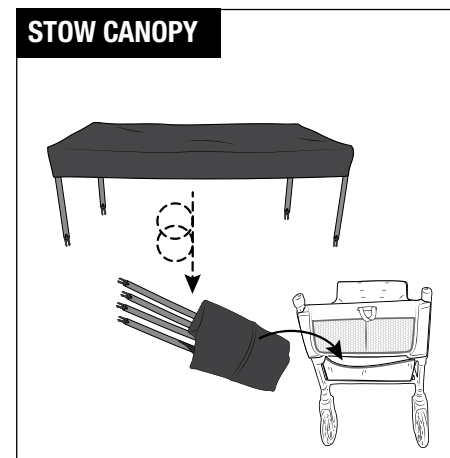
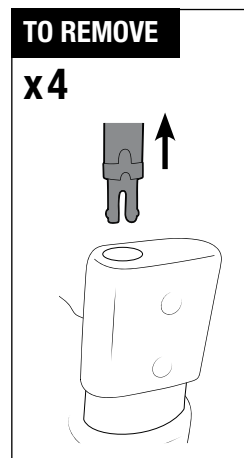
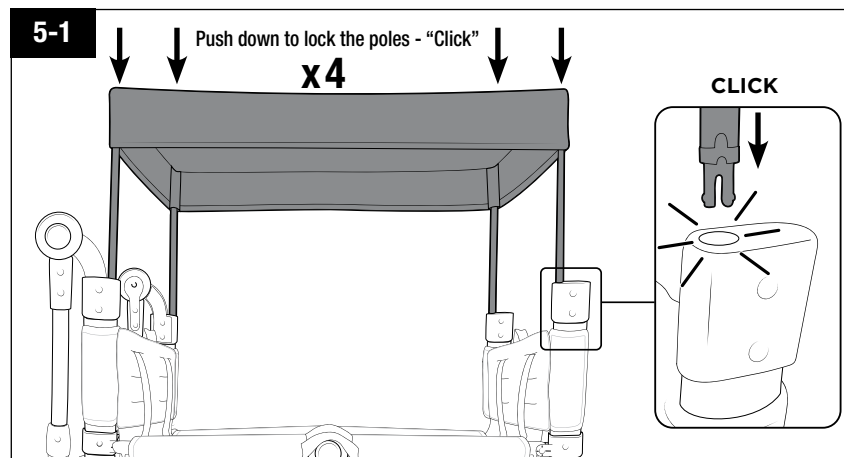

ADJUST HANDLE

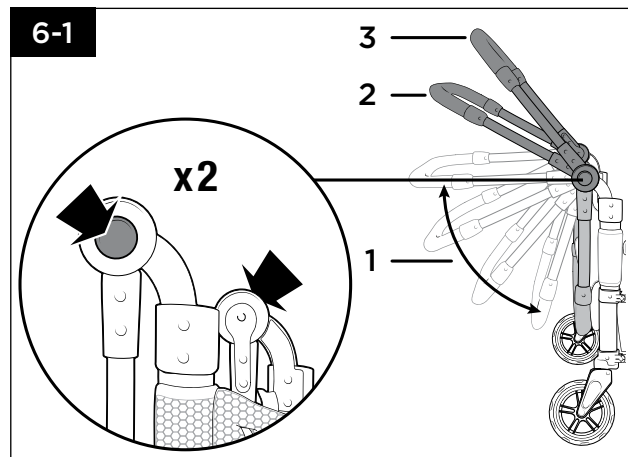

NAVIGATE CURBS

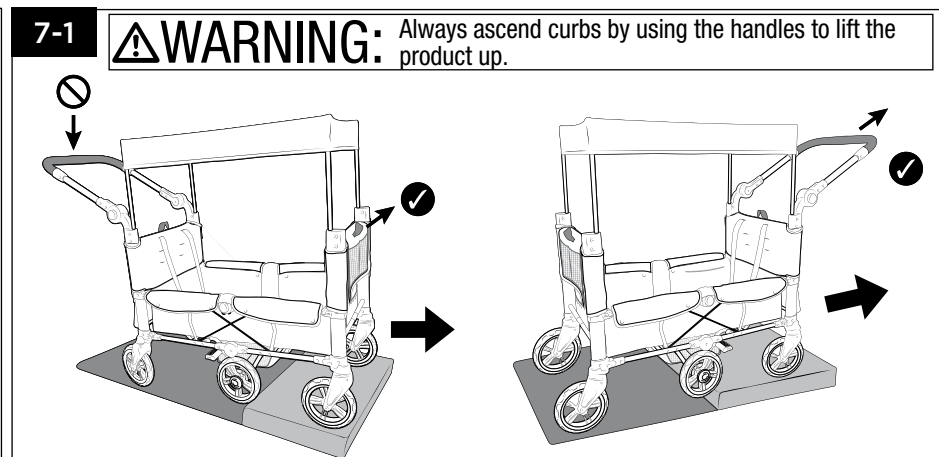

SECURE CHILD IN SEAT

8-1

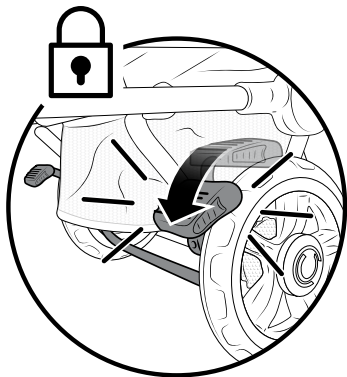

8-2

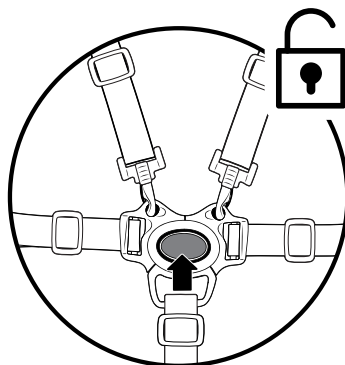

8-3

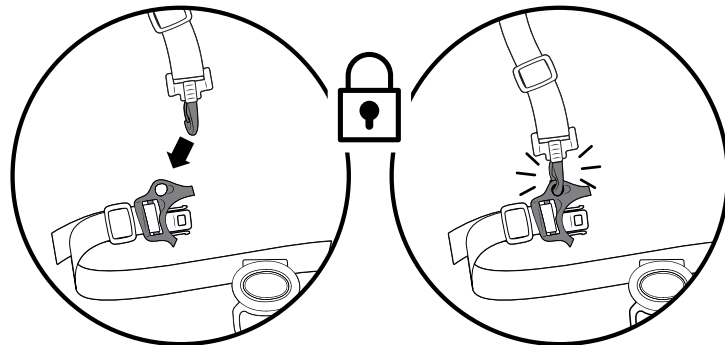

8-4

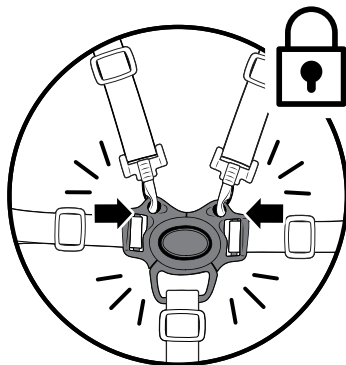

8-5

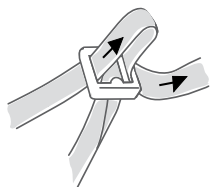

Adjust restraint harness
for a snug fit.

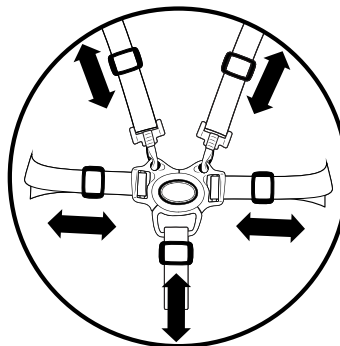

ADJUST SHOULDER STRAP HEIGHT

9-1

For the safest and most secure fit, the shoulder strap should rest comfortably just above your child's shoulder.

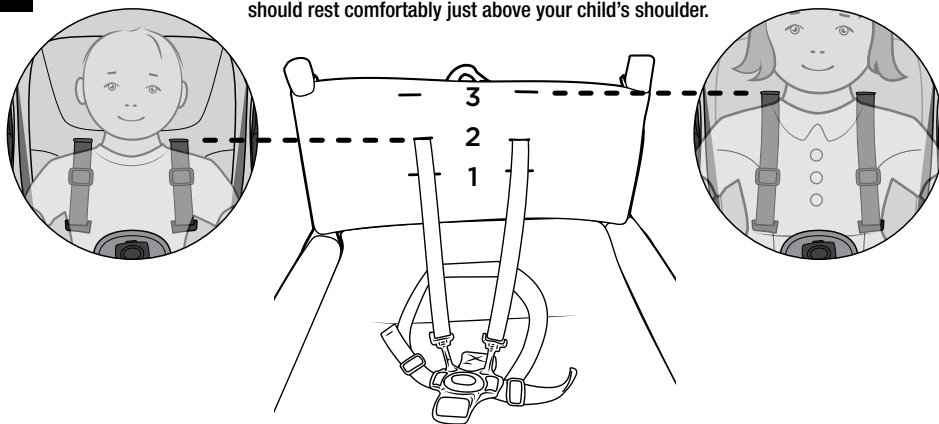

9-2

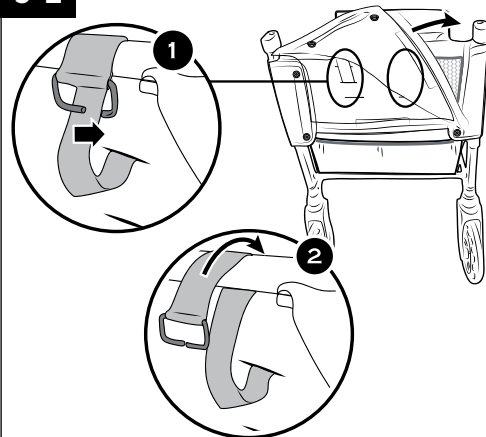

9-3

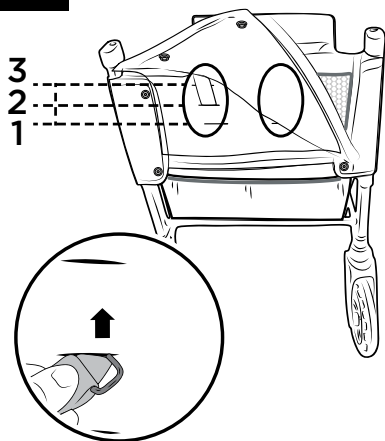

9-4

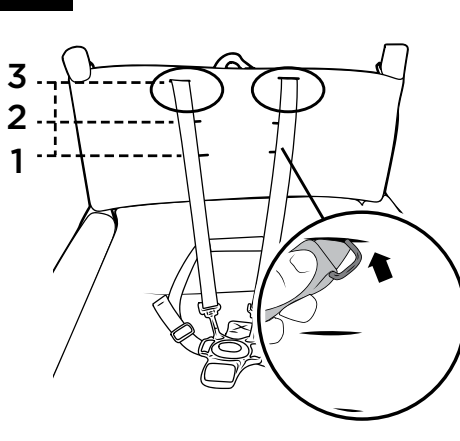

9-5

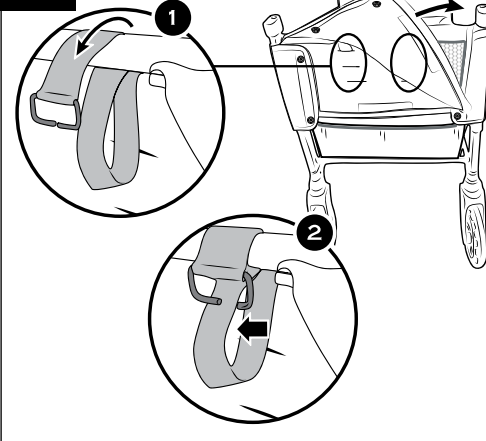

FOLD WAGON

10-1

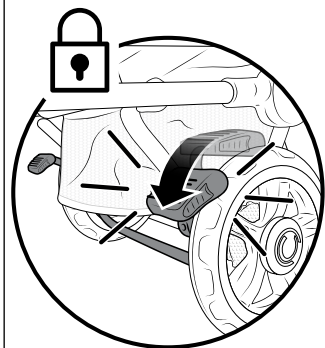

10-2

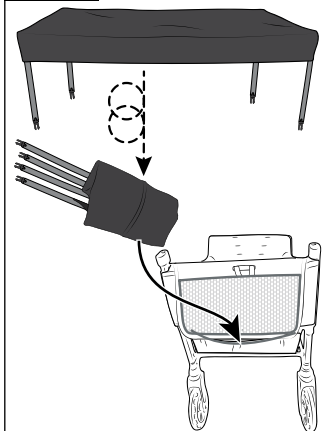

10-3

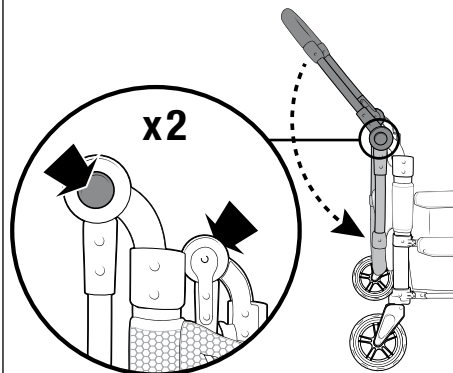

10-4

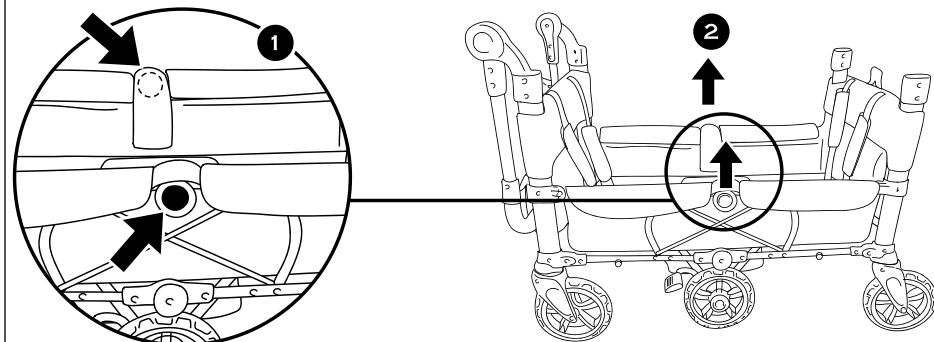

Push in buttons on both sides of frame simultaneously, then lift up on frame.

10-5

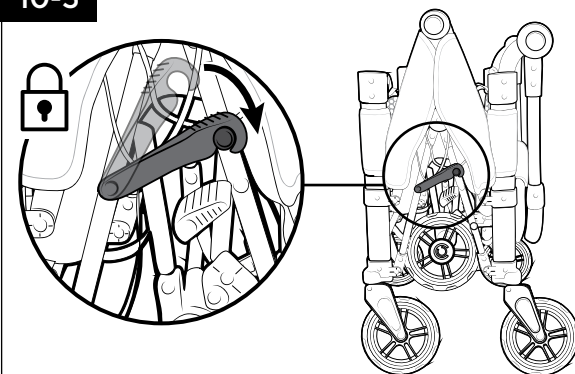

For the most compact fold, ensure wheels are all pointing in the same direction as shown in the illustration above.

STORAGE

PARENT STORAGE POCKETS

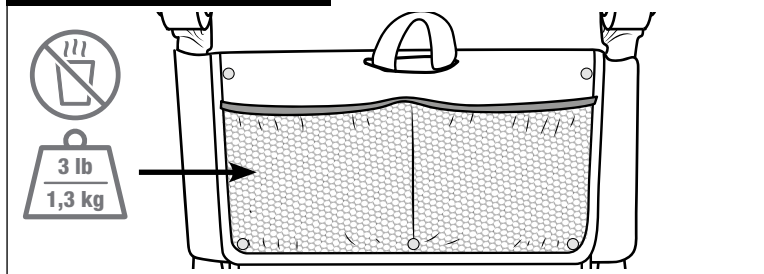

FRONT STORAGE POCKETS

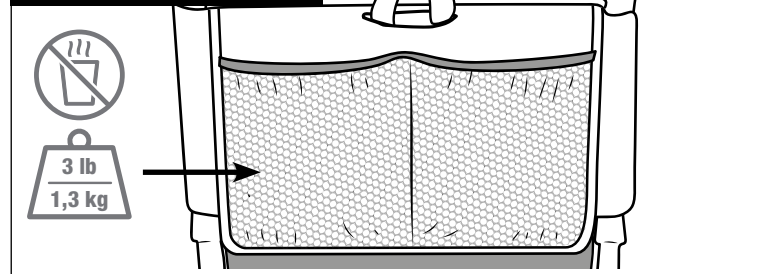

PARENT ORGANIZER

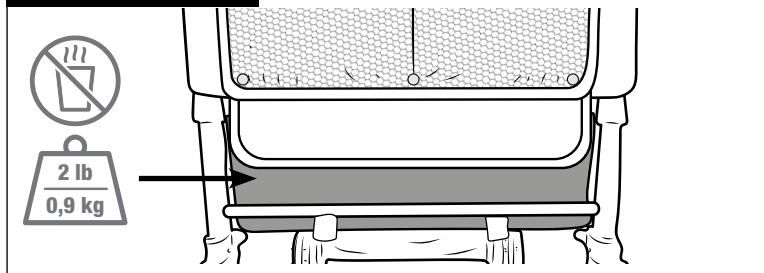

CANOPY STORAGE



INTERIOR STORAGE POCKETS

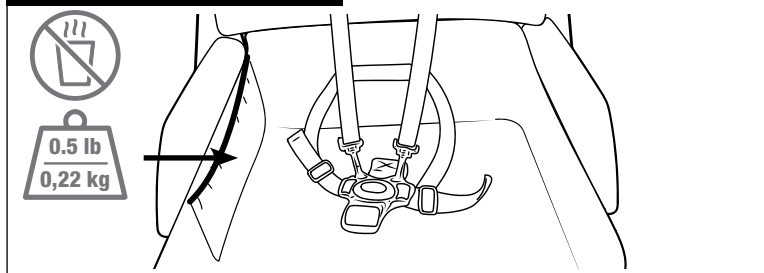

FOOTWELL STORAGE

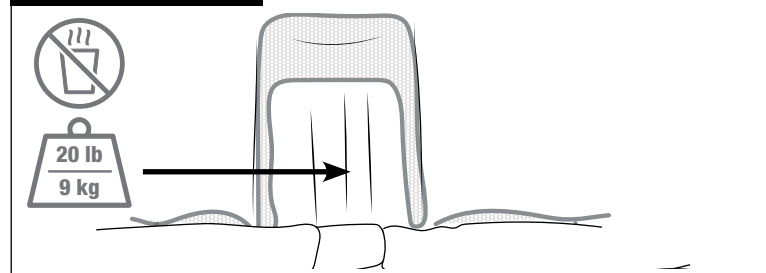

CARE & MAINTENANCE

- Clean hard parts with a damp cloth and wipe dry.
- Spot clean fabric with mild soap and water solution.
- If product becomes wet, wipe with a soft cloth to prevent rusting on metal frame.
- When storing product, never stack other items on top of or in it; this may damage the product.
- Periodically check for worn parts, loose screws, or torn materials and stitching.
- Replace any damaged parts immediately.

Please direct any comments, questions or replacement part requests to:

Kolcraft® Consumer Service Department

1100 W Monroe St. Chicago, IL 60607

1-800-453-7673 in USA & Canada, 1-312-361-6315 outside USA & Canada

Central Standard Time, 8 am-5 pm Monday - Thursday, 8 am - 3 pm Friday

e-mail: customerservice@kolcraft.com